

# Óleo Hidráulico, Manifolds e Conexões

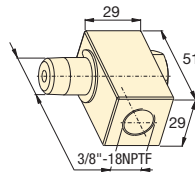

## Conector Giratório de 3/8".

Conector giratório de 360 graus para melhor orientação da ligação hidráulica entre cilindros, bombas e mangueiras. Peça o Modelo nº XSC-1.



## Série A, AM FZ, BFZ, HF, LX



Conexões 700 bar		Modelo	Dimensões (mm)				Diagrama	
			A	B	C	D		
<b>Cotovelo Macho/Fêmea</b>			<b>FZ-1616</b>	23	33	3/8" -18 NPTF	3/8" -18 NPTF	
De: 3/8" -NPTF Macho	Para: 3/8" -NPTF Fêmea							
<b>Luva de Redução</b>			<b>FZ-1615</b>	28	25	3/8" -18 NPTF	1/4" -18 NPTF	
De: 3/8" -NPTF Fêmea	Para: 1/4" -NPTF Fêmea							
			<b>FZ-1608</b>	38	16	1/4" -18 NPTF	1/4" -18 NPTF	
De: 1/4" -NPTF	Para: 1/4" -NPTF							
De: 3/8" -NPTF	Para: 3/8" -NPTF							
			<b>FZ-1619</b>	51	19	3/8" -18 NPTF	3/8" -18 NPTF	
De: 3/8" -NPTF	Para: 3/8" -NPTF							
De: 3/8" -NPTF	Para: 3/8" -NPTF							
<b>Niple Sextavado</b>			<b>FZ-1617</b>	37	19	3/8" -18 NPTF	3/8" -18 NPTF	
De: 3/8" -NPTF	Para: 3/8" -NPTF							
De: 3/8" -NPTF	Para: 3/8" -NPTF							
<b>Luva</b>			<b>FZ-1614</b>	29	23	3/8" -18 NPTF	3/8" -18 NPTF	
De: 3/8" -NPTF	Para: 3/8" -NPTF							
			<b>FZ-1605</b>	29	19	1/4" -18 NPTF	1/4" -18 NPTF	
De: 1/4" -NPTF	Para: 1/4" -NPTF							
<b>Cruzeta</b>			<b>FZ-1613</b>	45	25	3/8" -18 NPTF	-	
De: 3/8" -NPTF Fêmea	Para: 3/8" -NPTF Fêmea							
<b>Tê</b>			<b>FZ-1612</b>	45	25	3/8" -18 NPTF	-	
De: 3/8" -NPTF	Para: 3/8" -NPTF							
			<b>FZ-1637</b>	45	24	1/4" -18 NPTF	-	
De: 1/4" -NPTF	Para: 1/4" -NPTF							
<b>Cruzeta tipo Tê</b>			<b>BFZ-16312</b>	56	26	3/8" -18 NPTF	3/8" -18 NPTF	
De: 3/8" -NPTF Fêmea	Para: 3/8" -NPTF Male							
<b>Cotovelo</b>			<b>FZ-1610</b>	33	20	3/8" -18 NPTF	-	
De: 3/8" -NPTF	Para: 3/8" -NPTF							
			<b>FZ-1638</b>	36	24	1/4" -18 NPTF	-	
De: 1/4" -NPTF	Para: 1/4" -NPTF							
<b>Redutor</b>			<b>FZ-1630</b>	19	19	1/4" -18 NPTF	3/8" -18 NPTF	
De: 3/8" -NPTF	Para: 1/4" -NPTF							
De: 1/4" -NPTF	Para: 1/2" -NPTF							
			<b>BFZ-1630</b>	28	22	1/4" -18 NPTF	1/2" -14 NPTF	
De: 3/8" -NPTF	Para: G1/4"							
			<b>BFZ-16301</b>	19	19	G1/4"	3/8" -18 NPTF	
De: 1/4" -NPTF	Para: G1/4"							
De: 1/2" -NPTF	Para: G1/4"							
De: 3/8" -NPTF	Para: G3/8"							
<b>Adaptador</b>			<b>BFZ-16411</b>	35	19	1/4" -18 NPTF	G1/4"	
De: G1/4"	Para: 1/4" -NPTF							
De: G1/4"	Para: 1/8" -NPTF							
De: G3/8"	Para: 1/4" -NPTF							
			<b>BFZ-16421</b>	31	19	1/8" -27 NPTF	G1/4"	
De: G3/8"	Para: 1/4" -NPTF							
De: G3/8"	Para: 3/8" -NPTF							
			<b>BFZ-16323</b>	43	24	1/4" -18 NPTF	G3/8"	
De: G3/8"	Para: 3/8" -NPTF							
De: G3/8"	Para: 3/8" -NPTF							
<b>Adaptador</b>			<b>FZ-1055</b>	44	23	1/4" -18 NPTF	3/8" -18 NPTF	
Fêmea: 1/4" -18 NPTF	Macho: 3/8" -18 NPTF							
De: 1/2" -14 NPTF	Para: 1/4" -18 NPTF							
De: 1/2" -14 NPTF	Para: 3/8" -18 NPTF							
			<b>FZ-1633</b>	30	19	1/2" -27 NPTF	1/4" -18 NPTF	
De: 1/2" -14 NPTF	Para: 1/4" -18 NPTF							
De: 1/2" -14 NPTF	Para: 3/8" -18 NPTF							
			<b>FZ-1634</b>	42	28	3/8" -18 NPTF	1/2" -18 NPTF	
De: 1/2" -14 NPTF	Para: 3/8" -18 NPTF							
De: 1/2" -14 NPTF	Para: 3/8" -18 NPTF							
<b>Conexão Giratória</b>			<b>FZ-1660</b>	40	22	3/8" -18 NPTF	3/8" -18 NPTF	
De: 3/8" -NPTF Macho	Para: 3/8" -NPTF Fêmea							